



Froggy's Fog Hyperion SJ8 Super Jet Vertical Fog Machine - User Manual

Specifications

Technical specification

Voltage: AC 120V 60Hz

Fuse: 15A/250V

Power: 1800W

Heater Core: 1500W

LED Power: 10W*24pcs

LED Color: RGBAW+UV

Heat-up Time: 4min

Max Continuous Output Duration: 8s

Output: 54,000cuft/min

Fluid Consumption Rate: 270 ml/min

Max Output Height: 30 ft. Tank

Capacity: .66 Gal

N.W.: 35.3 lbs.

G.W.: 38.6 lbs.

Machine Size: 18.7 / 15.8 / 8 in

Package Size: 22.5 / 19 / 10.5 in

DMX Channel: 17

Compatible Fluids – Froggy's Fog Designer Select Series Water Based Fog Fluids

Diagram

1. Nozzle
2. LEDs
3. Fluid Tank
4. Tank Strap
5. Fluid Tube
6. LCD display
7. 3-pin DMX socket
8. 5-pin DMX socket
9. Fluid Level Window
10. Ventilation Slots
11. Handle
12. Safety Ring
13. Power switch
14. Power socket
15. Overload protector

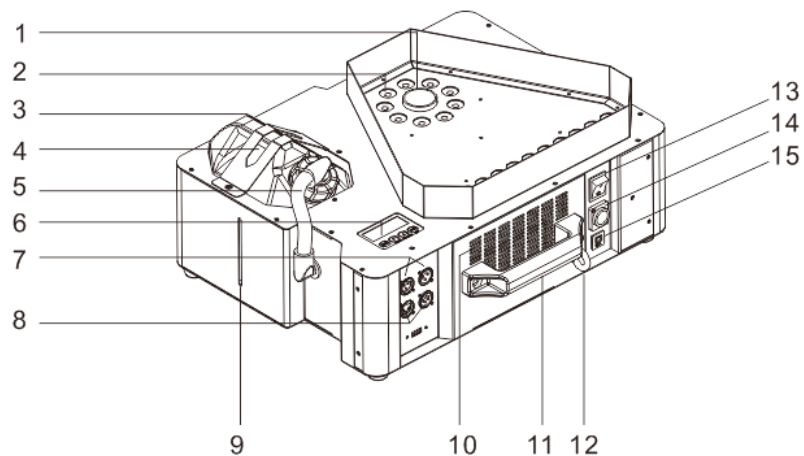

IMPORTANT

- Always use a grounded electrical outlet. Turn off or unplug the machine when not using it.
- This Machine can be used indoors and outdoors, but it is not water-proof. Please keep it away from moisture and water. If moisture, water or fluid gets inside the housing, stop using it.
- No user serviceable and modifiable parts inside. Do not disassemble the housing and do any modification, otherwise it might cause damage to the unit or danger of electrocution.
- For adult use only. Fixture must be installed out of the reach of children. Never leave the unit running unattended. Keep it away from fire as well as combustible and flammable materials.
- Position the machine in well-ventilated area.
- Please do not use the fixture under high temperatures.
- Only specifically designed water based scent additives may be added to the fog fluid. Never add flammable liquids of any kind (oil, gas, non-application specific perfumes). Pay attention to all warning labels and instructions printed on the exterior of your machine.
- Use only Froggys Fog fog Liquids. The fluid's optimal vaporization temperature coincides with the machine's heater core to give you efficient fog production and minimize incomplete vaporization.
- Never drink fog liquid. If it is ingested, call a doctor immediately for any discomfort. If liquid comes in contact with skin or eyes, rinse thoroughly with water.

SETUP

Unpacking and inspection

Immediately upon receiving the machine, carefully unpack the carton, check all content to ensure that all parts are present and have been received in good condition. If any parts appear damaged or mishandled from shipping, please do not power on the machine. Contact the manufacturer for further instruction.

What is included:

1. 1 x Hyperion SJ8 Super Jet Fog Machine
2. 1 x Power Cord
3. 1 x User Manual

Installation

1. After ensuring all the accessories are intact, position the machine on a flat surface.

2. Unscrew the fluid tank's cap and pour water based fog machine liquid into the tank carefully, then tighten the cap.
3. Insert and twist to lock the Seetronic power cord to the machine.
4. Upon activating the power switch, the machine starts heating up in the standby mode, during this time, the LCD panel will display "WARMING UP"
5. When the process of heating up finishes, the LCD display will show "Ready to Fog"

OPERATION

LCD Control

Please take note LCD Display and control is inoperable when the unit is connected to DMX.

- MENU - Scroll through setting menu
- UP - Multifunction – Increase / Activate timer mode
- DOWN - Multifunction – Decrease / Activate manual output
- ENTER – Multifunction – Select / Stop output



Menu:

Page	Screen display
Menu	Timer Interval 600S
Menu	Timer Duration 8S
Menu	Channel A 20
Menu	DMX512 Address 512

Color Macros	
Color 1	Inner Red, Outer Red
Color 2	Inner Green, Outer Green
Color 3	Inner Blue, Outer Blue
Color 4	Inner Amber, Outer Amber
Color 5	Inner UV, Outer UV
Color 6	Inner White, Outer White
Color 7	Inner Magenta, Outer Magenta
Color 8	Inner Yellow, Outer Yellow
Color 9	Inner Cyan, Outer Cyan
Color 10	Inner Red, Outer Amber
Color 11	Inner Amber, Outer Red
Color 12	Inner Green, Outer Red
Color 13	Inner Red, Outer Green
Color 14	Inner Red, Outer Blue
Color 15	Inner Blue, Outer Red
Color 16	Inner Cyan, Outer Yellow
Color 17	Inner Magenta, Outer Cyan
Color 18	Inner Yellow, Outer Green
Color 19	Inner Green, Outer Yellow
Color 20	Auto Color (Color 1-19 rotating every 1 second)

Remote Color Selection

At Channel A page, press ENTER button to LED color setting page. Press UP and DOWN to choose color. Press ENTER to save and exit the setting. There are total 20 LED color macros (19 colors + 1 random mixing mode) as well as an "Off" setting.

After setting the color, the corresponding color will light up when fog output is activated.

c). When Random mode, the LED will change color randomly, the interval is 1s.

Note:

When connected to DMX controller, the color setting from this page will be invalid, the LED color would be controlled by DMX controller

DMX

When connected DMX controller, the LCD will only display the DMX address setting page. The address is adjustable via the UP and DOWN buttons.

DMX Profile

Channel	Function	Value	
1	Fog	0-9 No Function	10-255 Fog on
2	Inner Red	0-9 No Function	10-255 0-100%
3	Inner Green	0-9 No Function	10-255 0-100%
4	Inner Blue	0-9 No Function	10-255 0-100%
5	Inner Amber	0-9 No Function	10-255 0-100%
6	Inner UV	0-9 No Function	10-255 0-100%
7	Inner White	0-9 No Function	10-255 0-100%
8	Outer Red	0-9 No Function	10-255 0-100%
9	Outer Green	0-9 No Function	10-255 0-100%
10	Outer Blue	0-9 No Function	10-255 0-100%
11	Outer Amber	0-9 No Function	10-255 0-100%
12	Outer UV	0-9 No Function	10-255 0-100%
13	Outer White	0-9 No Function	10-255 0-100%
14	Color Macro	0-9 No Function	10-255 (See Color Macro List)
15	Auto Color	0-9 No Function	10-255 Color 1-19 rotating, Speed slow to fast
16	Strobe	0-9 No Function	10-255 Strobe, slow to fast
17	Dimmer	0-9 No Function	10-255 0-100%

FLUID SENSOR

This machine uses an electronic program to detect when fluid is present to protect the pump from being damaged in the event of an empty fluid tank. After 20s of fluid less operation, the machine activates the low fluid prevention system, noted on the display.

Resetting the Low Fluid Sensor

After refilling the fluid tank, there are two ways to release the protection.

a). Keep pressing Volume button until the fog liquid fills the intake tube completely, then the machine will exit low-fluid protection.

B). Under the DMX control, reduce CH 1 below 10 (Fog OFF), then increase value above 10 (Fog ON).
The machine will exit low-fluid protection

ALTERNATE POSTIION

You may also use the fog machine in an upside down suspended orientation

- Make sure the structure of surface onto which you are mounting the product can support the product's weight.
- When mounting the product overhead, always use a safety cable. Mount the product securely to a rigging point, such as an elevated platform or a truss
- When rigging the product onto a truss, you should use mounting clamps of appropriate weight capacity.

Remove the screw and the bottle lock to take out the tank

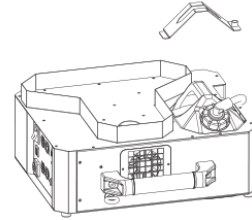

Turn the fog machine upside down and remove the screws to take off the removable plate

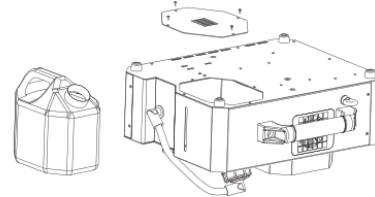

Attach the removable plate to the opposite side and secure the tank with the bottle lock

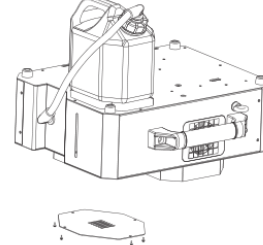

SERVIC & MAINTENANCE

- Excessive dust, fluid residue and dirt will degrade performance and cause overheating.
- Remove dust from air vents with air compressor, vacuum or a soft brush.
- The casing can be cleaned by the damp cloth.

Cleaning your Fog machine regularly will help reduce costly parts replacement and repair charges.

Please follow these instructions for safely cleaning your Fog machine if output become noticeably decreased. Typical service intervals are every 40 hrs. of machine use. High quality fluid recommended by the manufacturer lengthens the amount of time between periods of maintenance as described below.

Tools: Clean lint free cloth, coffee filter or similar fine mesh filter cloth, plastic or glass container larger than the reservoir size (do not use metal), distilled water and Froggy's Fog fluid.

1. Allow the machine to cool down before handling.
2. Drain any Fog solution that remains in the tank into a container through the filter mesh for reuse.
3. Add distilled water to fill the Fog fluid reservoir approximately 1/3.

4. Run machine for 10 minutes. Fog will come out the first few cycles, followed by distilled water steam.
5. Turn off the machine and allow to cool down, then drain the distilled water from the reservoir.
6. Refill the reservoir approximately 1/3 with good quality Fog solution.
7. Turn the machine on, run for 10-15 minutes. Water vapor steam will come out the first few cycles, followed by fog. Continue steaming the machine for 5-10 cycles.
8. Turn off the machine and allow to cool, then wipe machine clean with clean lint free cloth.
9. Leave the Fog solution in the reservoir. The solution acts a lubricant and conditioner for the plastic and rubber parts in the fluid pump.
10. Store the machine in a cool, dry place when not in use. Avoid freezing temperatures, high heat above 120 degrees and humid/damp locations which may cause control board issues and should be avoided.
11. If possible, remove from storage after 6 months and operate the machine for 15 minutes or more, then repeat step 8 – 10.

WARRANTY INFORMATION

Save these instructions. 2 Year Limited Warranty: Valid from the date of purchase. Warranty covers manufacturing defects only and does not cover misuse or abuse of the machine. Serial number, place of purchase with dated valid receipt must be submitted at time of service. Warranty is only valid with-in the United States. Buyer may be responsible for shipping fees associated with repairs.